

T5 / T6 / T7 GEARCASE REPLACEMENT PROCEDURE

PARTS REQUIRED:

M12040 - Inner Gearcase Assembly

TOOLS REQUIRED:

Phillips (cross recess) screwdriver

Flat blade screwdriver

Hammer

- 1) Remove the screws that attach the gearcase cover to the outer gearcase and remove cover. (see FIG 1)

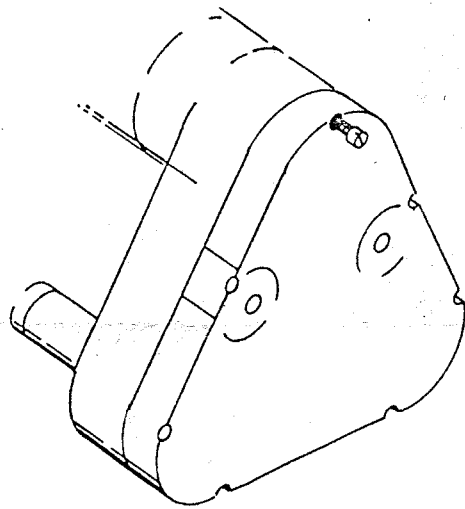

(FIG 1)

- 2) Remove both drive belts by removing the (2) pulley caps and the (2) pulley flanges, pry off belts (see FIG 2)

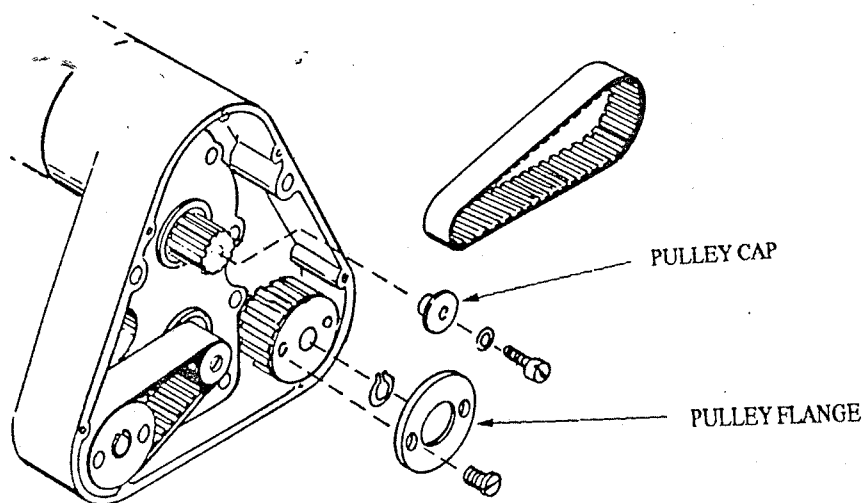

(FIG 2)

- 3) Remove the (9) screws that attach the inner gearcase and lift from the outer gearcase.
(Note: T6 Models with serial numbers greater than 36682 and all T7 models are pinned in two places and require prying the inner gearcase with a tool such as a screwdriver.)
Retain the gasket for re-assembly. (see FIG 3)

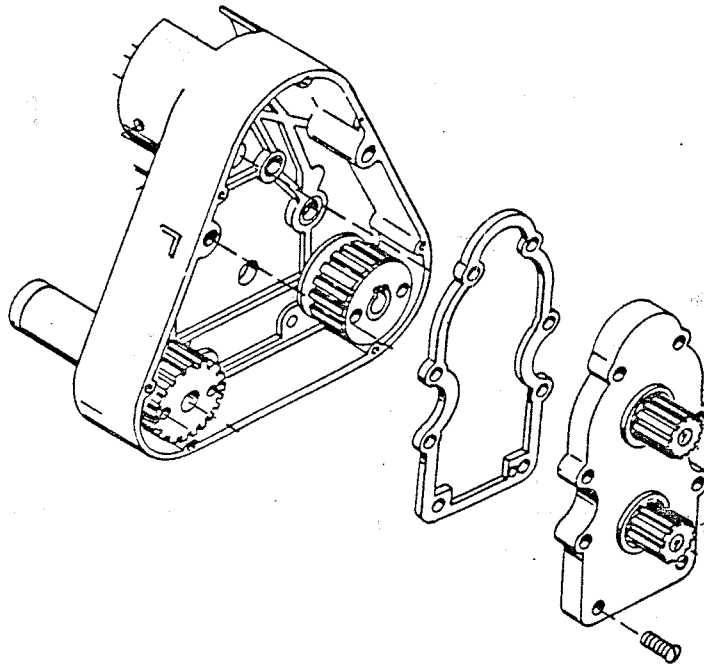

- 4) Install the pre-lubricated inner gearcase assembly into the outer gearcase, being certain to mesh the upper gear with the motor pinion. Install the nine (9) screws removed in step 2. (replace two pins, if applicable)
- 5) Install both drive belts, pulley caps, and pulley flanges removed in step 2.
- 6) Install the gearcase cover removed in step 1.
- 7) If the machine is under warranty, return the old gearcase to the "HOST" factory.