

Job Element Sheet

Mgr.	Eng.	Eng.	Eng.
------	------	------	------



Element or Process Name

T-71 Freestyle Service - Brush Unit

Required PPE				First issue date	
1	Gloves	4	Safety shoes	7	14/07/2014
Revision		Revision			
2	Goggles	5	Overalls	8	06/03/2015
3	Ear defenders	6	Mask	9	03/05/2016

#	Major step	#	Major step	#	Major step	Part Numbers (P/N)			
1	Remove velcro skirts and brushes		P/N-5		wires from RFI filter, P/N-9 (pic 6)	1	M30684	11	V115
2	Remove gear case cover screws (pic1), P/N-1, and gear case cover P/N-2	7	Remove screws from each side of shroud at gear case end (pic 5) P/N-5	11	Remove screws, P/N-10 from exhaust duct and place shroud to one side (pic 7)	2	M30614	12	
3	Remove handle assembly screws (pic 2) P/N's-3&4. Put handle to one side (3A)	8	Unscrew and remove lever lock (pic 5) P/N-8	12	Remove screws P/N's-11&12 from brush shroud and place to one side (pic 8)	3	M30675	13	
4	Remove nuts and bolts from brush release end of shroud (pic 3), P/N's-5&6	9	Partially remove shroud to access wires, by pulling up and away from motor house- ing and to one side	3A	Put spacer to one side	4	M30673	14	
5	Remove brush guard release button (pic 3) P/N-7	10	Remove earth wire from terminal block situated on motor exhaust duct. Unclip			5	H1072	15	
6	Remove screws from vac inlet (pic 4)					6	466A	16	
						7	M30224	17	
						8	M30085	18	
						9	U1193	19	
						10	M30215	20	

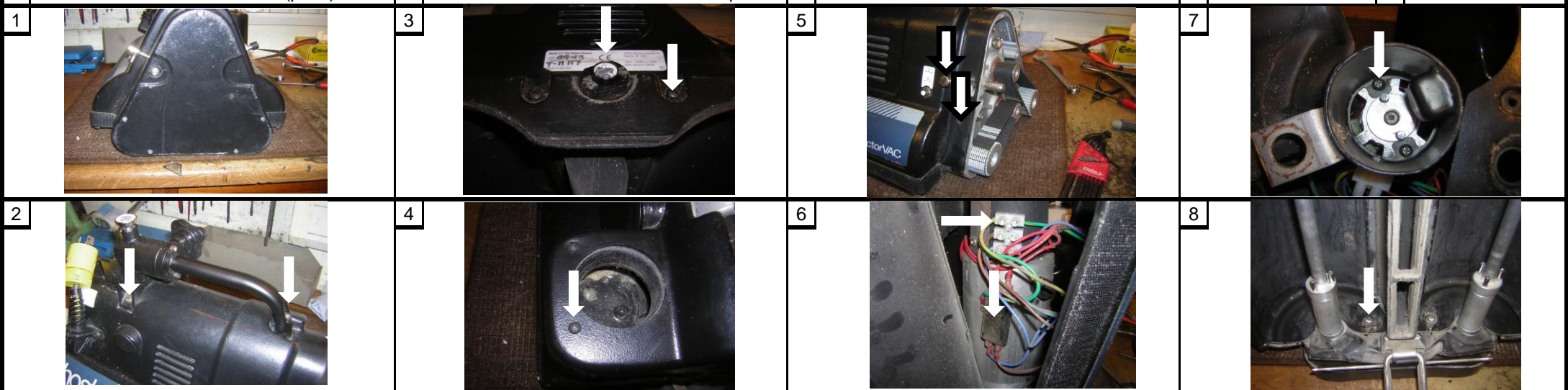

>>>>> Ensure that all work is carried out and/or checked by a qualified engineer <<<<<<

Job Element Sheet

Mgr.	Eng.	Eng.	Eng.
------	------	------	------



Element or Process Name	Required PPE				First issue date	
	1	Gloves	4	Safety shoes	7	14/07/2014
T-71 Freestyle Service - Brush Unit	2	Goggles	5	Overalls	8	Revision
	3	Ear defenders	6	Mask	9	06/03/2015
						03/05/2016

#	Major step	#	Major step	#	Major step	Part Numbers (P/N)			
13	Remove screws securing brush guard		shaft gear (pic 4)		(Castrol LMX or equivalent)	1	V115	11	M50385
	P/N-1 (pic 1)	19	Remove gear using suitable pulley/lever	25	Remove screw bolts ,P/N-9 securing	2	M30686	12	
14	Remove end skirt P/N-2	20	Tap out woodruff key, P/N-5, and remove		motor housing and remove (pic 6)	3	M12011A	13	
15	Remove screws (x9) from gearcase,		nylon washer, P/N6 (pic 5)	26	Remove carbon brush caps, P/N-10, and	4	M2008	14	
	P/N-3 (pic 2)	21	Remove brush shaft		carbon brushes, P/N-11 (pic 7)	5	34A	15	
16	Using suitable tool, prise off gear case	22	Check brush shaft bearings for wear,	27	Remove nuts from end of housing to	6	M2005	16	
	(pic 3) and remove drive belts		P/N-7		enable housing to be parted (pic 8)	7	M11109A	17	
17	Cover gear case with plastic to	23	Check brush shaft for wear, P/N-8			8	M30541	18	
	prevent contamination.	24	Replace brush shafts in reverse sequence			9	F2771	19	
18	Remove circlips, P/N-4, from brush		applying a little grease onto bearings			10	1213	20	

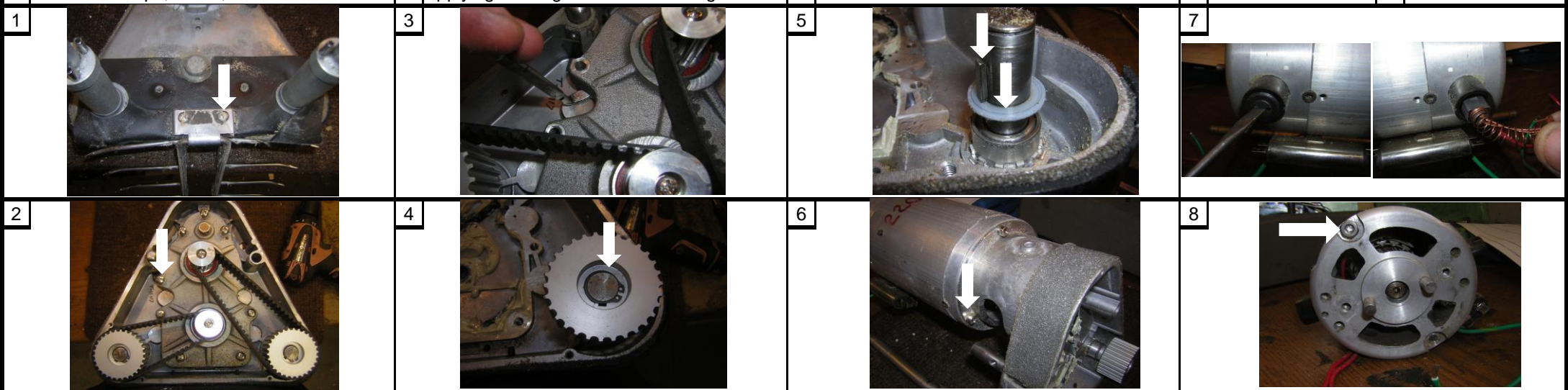

>>>>> Ensure all work is carried out and/or checked by a qualified engineer <<<<<<

Job Element Sheet

Mgr.	Eng.	Eng.	Eng.
------	------	------	------



Element or Process Name	Required PPE				First issue date	
	1	Gloves	4	Safety shoes	7	14/07/2014
T-71 Freestyle Service - Brush Unit	2	Goggles	5	Overalls	8	Revision
	3	Ear defenders	6	Mask	9	03/05/2016

#	Major step	#	Major step	#	Major step	Part Numbers		
1	Carefully part motor housing using suitable lever and remove armature	5	Check bearings for any wear and play, and replace as necessary, using bearing press/puller. P/N-3 (pic 1&2)	8	Check drive belts, P/N's_8&9, and replace if needed	1	M50383	10
2	With air line, blow out motor housing and field assembly, to remove dust and debris	6	Rebuild motor housing in reverse of disassemble	9	Replace all parts in reverse order, ensuring all areas of machine are clean/cleaned as you rebuild.	2	M50384	11
3	With air line, blow out armature to remove dust and debris	7	Check gear case gears, P/N's-4&5, bearings, part no.6 and shafts, P/N-7 for wear and damage (pic3&4). Replace if needed using suitable puller/press	9	Clean all external areas of machine	3	D443	12
4	Check armature, P/N-1 and field assembly, P/N-2 for excessive wear or damage and replace if needed			10	Test all equipment for any faults using appropriate testing equipment i.e. insulation/PAT test	4	M50357 (L/H)	13
						5	M50356 (R/H)	14
						6	M50352	15
						7	M30616	16
						8	M12014B	17
						9	M12015B	18

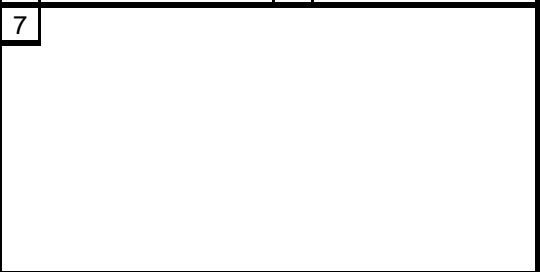

8

[N.B. Additional part numbers can be found in the parts manual that came with the machine or at \[www.hostvonschradler.co.uk\]\(http://www.hostvonschradler.co.uk\)](#)

>>>>> Ensure that all work is carried out and/or checked by a qualified engineer <<<<<<

Job Element Sheet

Mgr.	Eng.	Eng.	Eng.
------	------	------	------



Element or Process Name	PPE (delete as applicable)				First issue date	
	1	Gloves	4	Safety shoes	7	14/07/2014
T-71 Freestyle service - Vac Pod Unit	2	Goggles	5	Overalls	8	Revision
	3	Ear defenders	6	Mask	9	Revision
						06/03/2015
						03/05/2016

#	Major step	#	Major step	#	Major step	Part Numbers		
1	Remove filter housing and filters		P/N-5, from motor assembly (pic 6)	12	Ensure all areas of machine are clean and debris free when reassembling	1	M30145	11
2	Remove bagless recovery hopper	7	Remove plastic shroud from top of motor (pic 7)	13	Test vac	2	M7053B	12
3	Remove screws from top inlet P/N-1 and side vent screws P/N-1 (pic 1&2)	8	Remove fan cover (pic7)	14	Test filter warning light by running vac and using palm of hand, slowly cover top inlet. Warning light should light at around 90% coverage.	3	M30216	13
4	Remove back vent (pic 3) P/N's-1&2	9	Remove carbon brush assembly x 2, P/N-6 (pic 8)	15	Blow out and replace filters, filter housing and bagless hopper.	4	M30016	14
5	Carefully pull out motor from back of pod, for access, leaving all wires connected (pic 4&5)	10	Using appropriate PPE (see list) blow out motor using high pressure air line to remove carbon dust and debris	16	Clean and test machine	5	M30171	15
6	Whilst insitu remove 4 screws, P/N-3, Securing plate, P/N-4, and 2 clips	11	Replace all parts in reverse order.			6	12-LB-05 (pair)	16
						7		17
						8		18
						9		19
						10		20

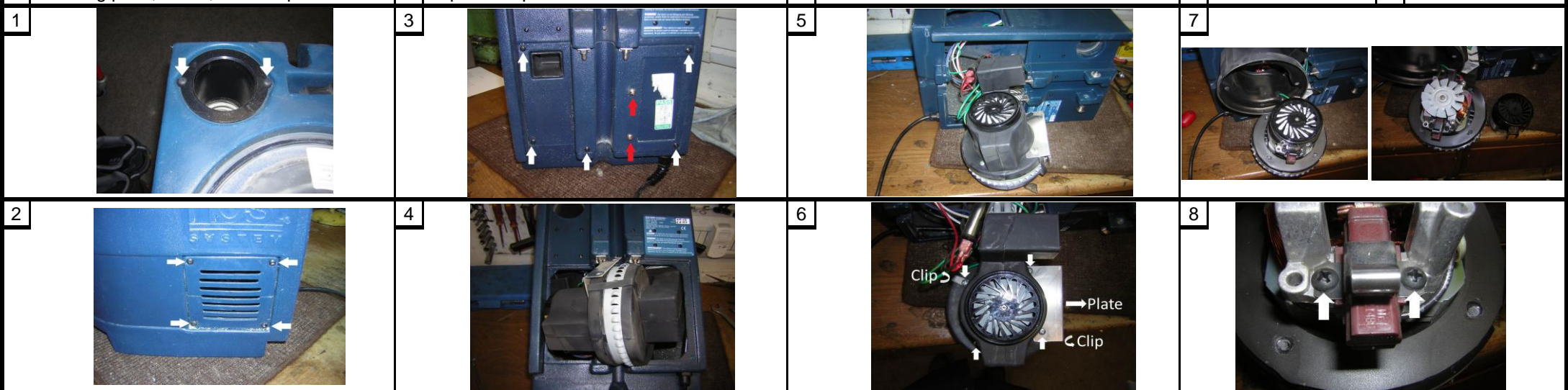

>>>>> Ensure all work is carried out and/or checked by a qualified engineer <<<<<<